



Scan here to get vip service



<https://magiccos.afterservice.vip>

TEL:+1 (833) 306 1883



PART# 1.8L PLASTIC BLENDER JAR

After Sales Support

Contact us : support@magiccos.co

Thanks for choosing our blender attachment.

Note:

This blender attachment is only used for Magiccos food processor, the related models are FP408, FP406, P415, FP413, FP416. Standard working time is 1 minute, always add water or liquid before using, please do not let blender attachment work for more than 3 minutes per time to keep a longer life time. The max level is 1800 ml, please add much lesser milk to avoid milk froth and leakage.

Blender Assembly

(Please refer to below assembly picture for FP413, FP415, FP416, FP408, FP406)

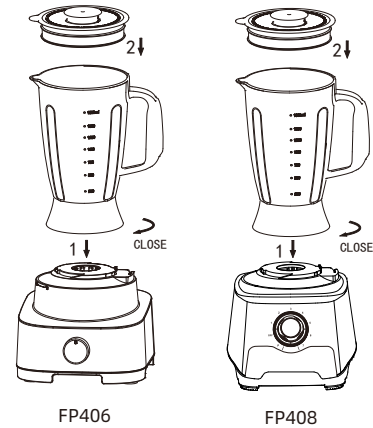
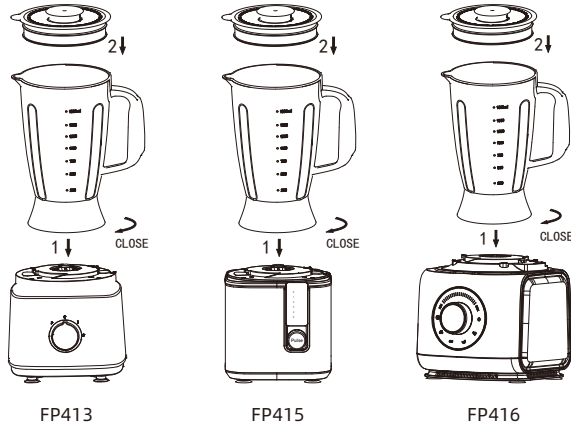

Blender Assembly (For example), please follow below steps for using

1. Make sure the blade base is fixed tightly.
2. Put food into the blender jar.
3. Install measuring cup and cover properly.
4. Put blender jar onto motor base vertically, and then rotate the jar clockwise to fix it.

Tips and Warning

- Always add water or liquid before using.
- Choose PULSE function for pre-mixing is recommended before operation.
- Not more than 1800ML for one batch.
- Make sure the blade base is installed properly before operation.
- Center measuring cup on the lid can be used to add ingredients during operation.